

Mobile Based – First Connection



- Some things that will need to be obtained before starting.
 1. Mobile device with Android or Apple Operating System
 2. Inline Mini or Inline 7
 3. Mobile SRV Subscription
 4. WI-FI or cell service



Mobile Based – First Connection

- Go to the device's app store and search for Cummins Guidanz. This app will need to be downloaded to the device.

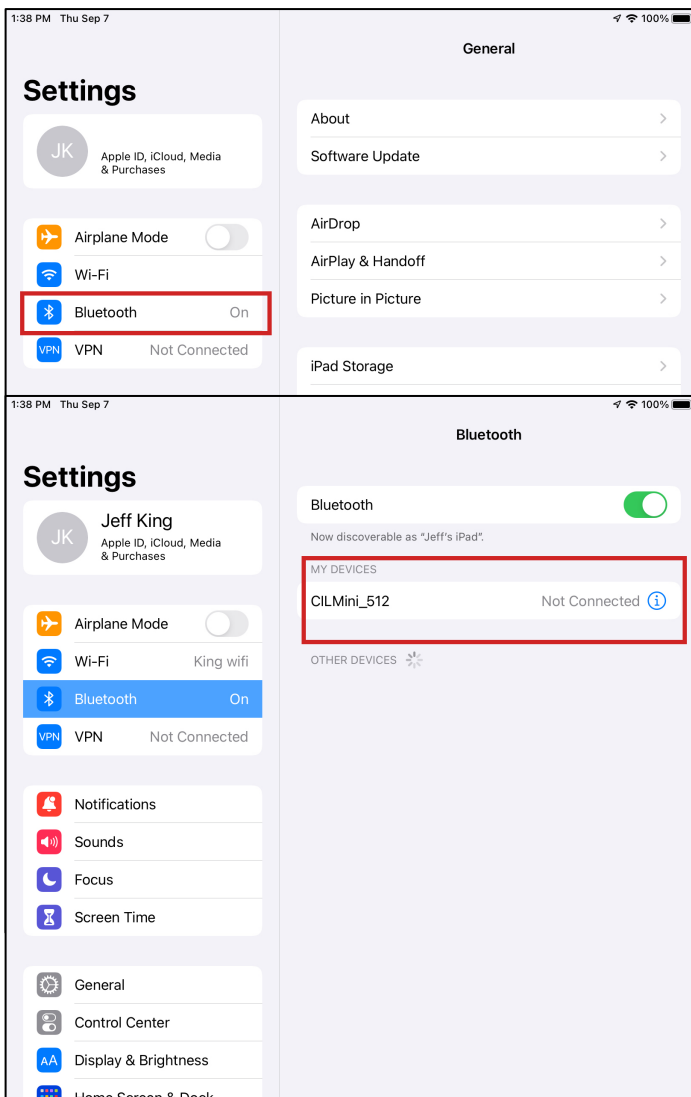
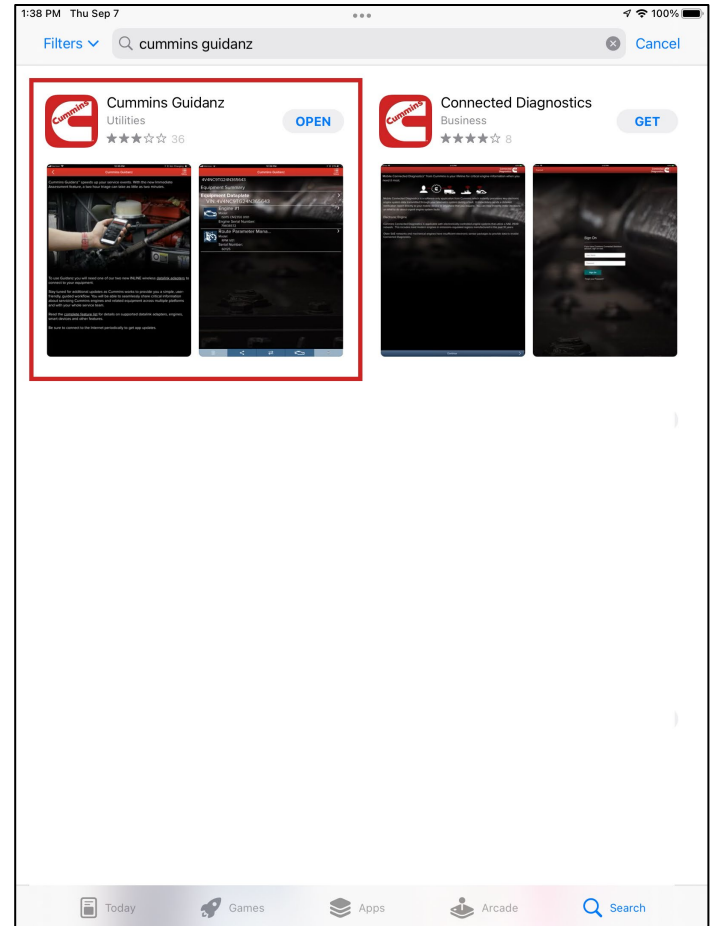

- Go to the device setting, select Bluetooth. Once the Mini or Inline 7 is plugged into the truck, it will show as a pairable device. It will need to be paired to the mobile device to be used.

Mobile Based – First Connection

- Choose the way to login into the Mobile app.

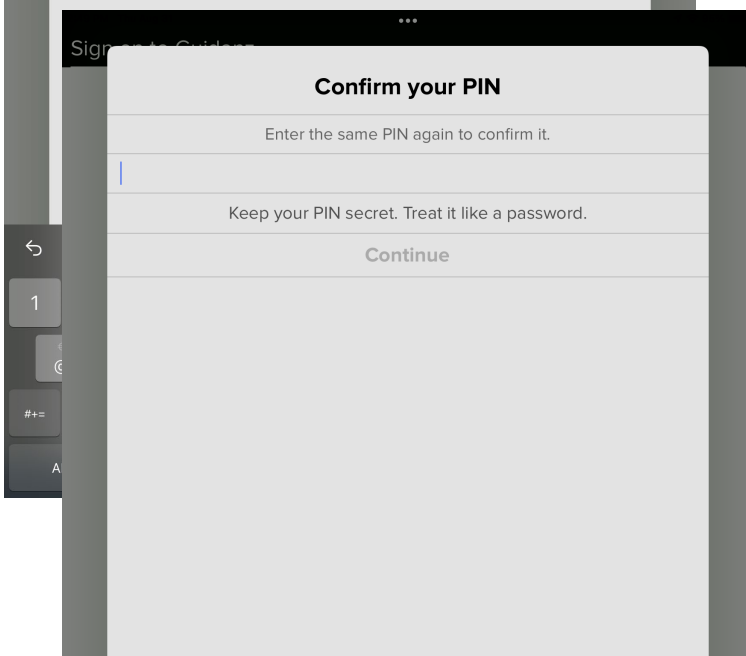
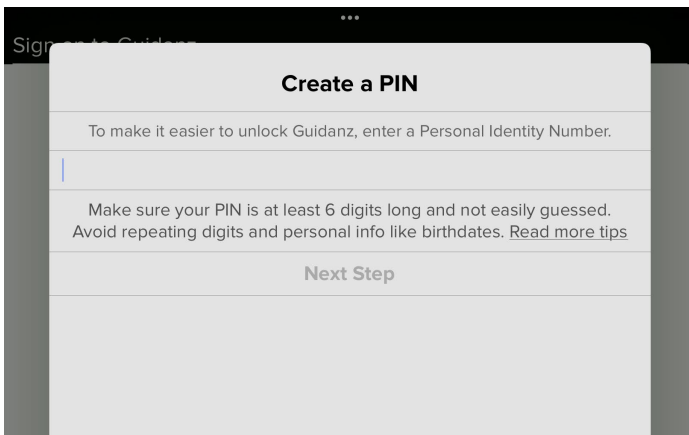
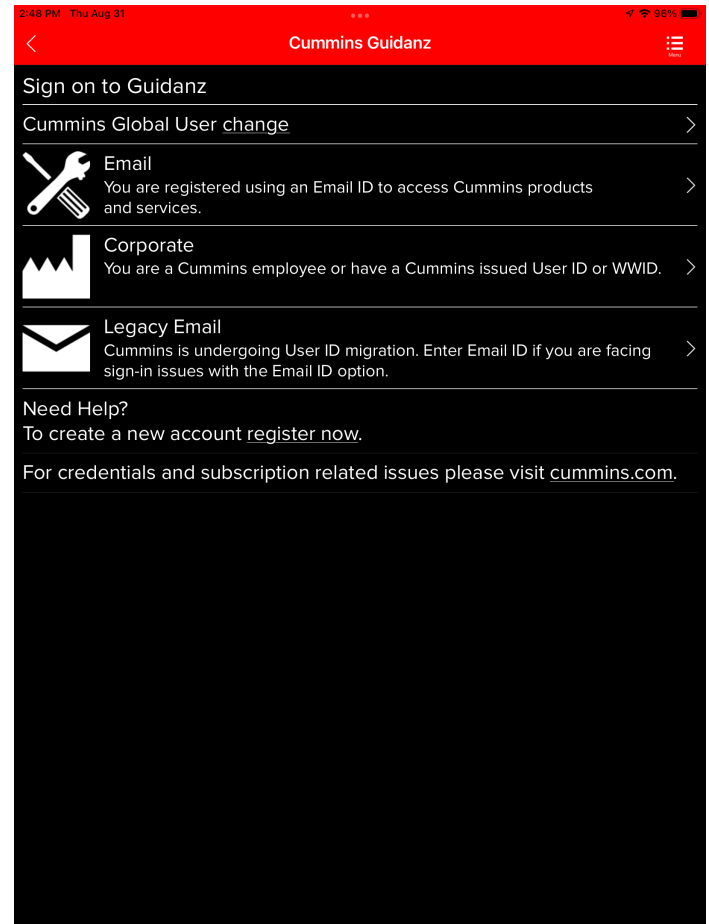

- Create a PIN. This PIN will be used to login into the app each time after the initial login session.