

## MODEL 750

JAKE BRAKE® FOR  
DETROIT DIESEL®  
SERIES 50 ENGINES

THE ORIGINAL

**JAKE  
BRAKE**®

by  
**Jacobs**®

- Available for 8.5-liter Series 50 engines
- Two braking levels for superior control
- Available for OEM installation
- Fits under the standard valve cover for simple installation
- Two-year unlimited mileage warranty

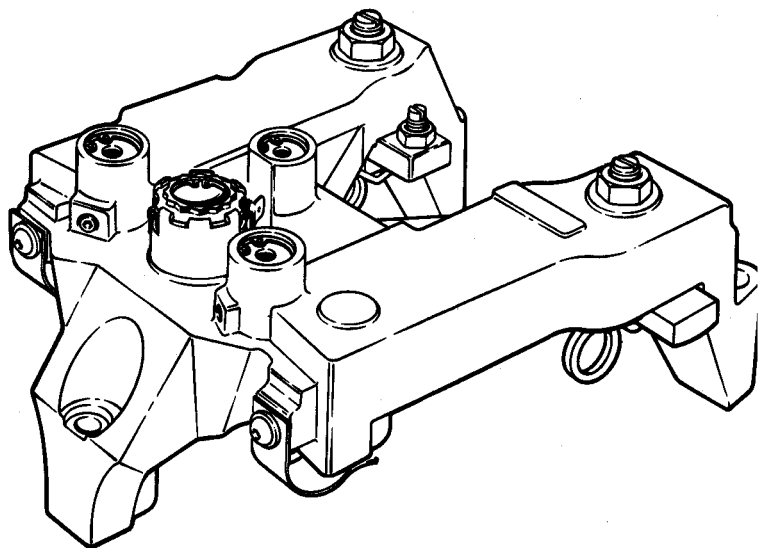

### MODEL 750 PERFORMANCE

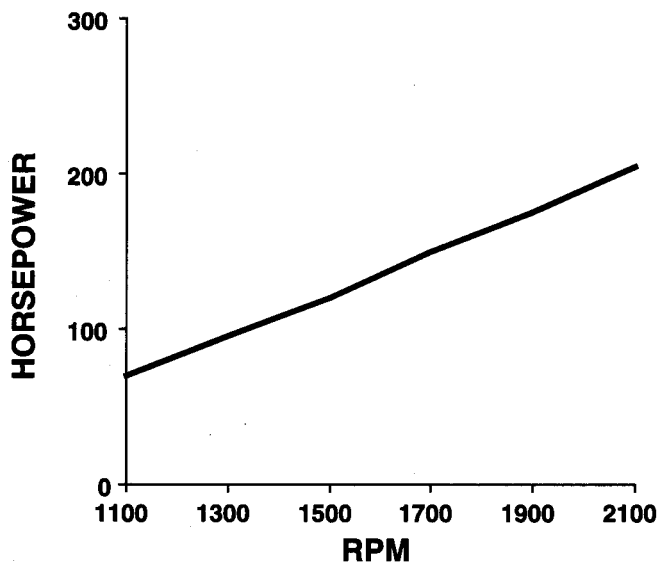

### MODEL 750 Retarding HP

RPM	HP
1100	70
1300	95
1500	120
1700	150
1900	175
2100	205

All horsepowers listed at SAE standard atmospheric conditions

# JACOBS® ENGINE BRAKES FOR DETROIT DIESEL® ENGINES BRAKE MODEL 750



## ENGINE BRAKE MODEL 750 (Two housings, each controlling two engine cylinders)

<b>Overall Dimensions of Basic Engine Brake Housing</b>	<b>in.</b>	<b>mm</b>
Height	5.5	140
Length	11.3	287
Width	9.0	229
<b>Added Engine Height (Valve Cover Spacers)<sup>1</sup></b>	0	0
<b>Weight of Standard Engine Brake Kit</b>	<b>lb.</b>	<b>kg</b>
Shipping Weight	67	30
Added Vehicle Weight <sup>2</sup>	59	27
<b>Number of Housings per Kit</b>	2	
<b>Torque Specifications</b>		
Housing Hold-down Capscrews	80 lbft. (110 N•m)	
Slave Piston Adjusting Screw Locknut	45 lbft. (61 N•m)	
Solenoid Valve	60 lbin. (7 N•m)	
Slave Piston Leveling Screw Locknut	35 lbft. (47 N•m)	

## Engine Brake Applications and Adjustment

Model No.	Engine Model Year	Liter	Jake Brake® Model	Slave Piston Lash Adjustment	Slave Piston Adjusting Tool P/N
6047GU28	1992	8.5	750	0.026 in. (0.660 mm)	017671

- The slave piston adjustments shown here are current as of the printing date.
- Engine model identification is on the name tag located on the side of the valve cover and stamped on the cylinder block beneath the intake manifold.

<sup>1</sup> Added height refers to overall vertical increase.

<sup>2</sup> Because some engine brake components replace standard engine parts, added Vehicle Weight does not necessarily equal weight of pre-installed Jacobs Engine Brake.

**Jacobs® Vehicle  
Equipment Company**  
22 East Dudley Town Road  
Bloomfield, CT 06002 USA