



E BRAKE
by Jacobs®

For Dodge Ram Trucks Equipped with the
Cummins ISB5.9 Engine
and a Manual Transmission

Parts Manual

Application Notes

The Cummins E Brake by Jacobs has been specifically engineered for Dodge Ram trucks equipped with the Cummins ISB 5.9 Turbo Diesel engine. For 1998 1/2, 1999, 2000, 2001 and 2002 installations, order kit P/N 3800780. This kit includes all parts from sections A-D.

Important!

For all 99, 2000, 2001 and 2002 model year trucks, the Engine Control Module (ECM) has been preprogrammed for exhaust brake operation. All 98 1/2 trucks may need an ECM Service Calibration performed by an authorized Cummins Distributor before the E Brake will operate. If you have not already had this Service Calibration performed, see your Cummins distributor for details.

For Manual Transmission Only!

For additional information or technical support, contact Cummins Customer Assistance Center by calling 1-800-DIESELS (1-800-343-7357)



THE EXHAUST BRAKE ASSEMBLY IS NOT FIELD SERVICEABLE. DO NOT ATTEMPT TO DISASSEMBLE E BRAKE COMPONENTS OR DAMAGE TO THE E BRAKE MAY OCCUR.

A. E Brake Assembly Group, P/N 3800779

III. No.	P/N	Description	Qty./ Group
1	3870839	E Brake assembly	1
2	3535001	Gasket	1
NI	3530556	Capscrew	5

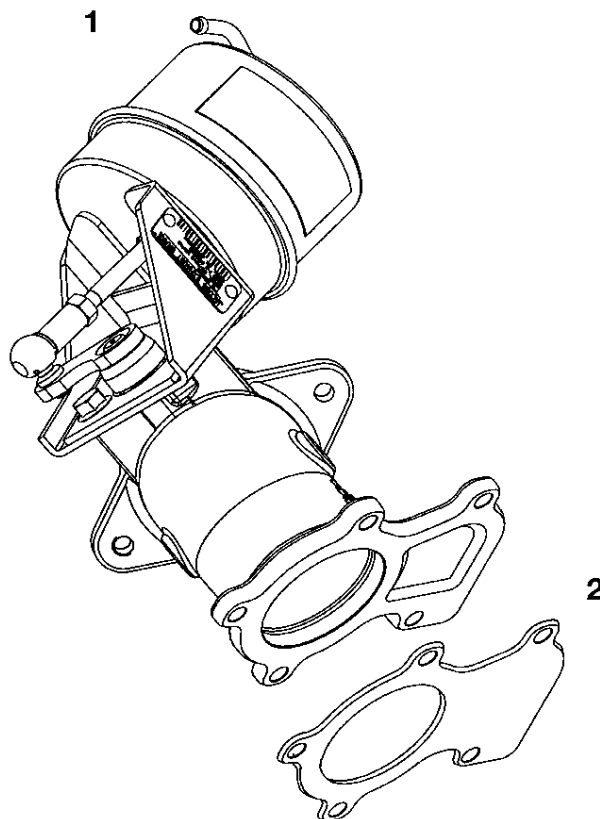

B. Wire Harness, P/N 3870864

III. No.	P/N	Description	Qty./ Group
1	NSS	Wire Harness	1
NI	NSS	O-Ring, Fuel Filter	1

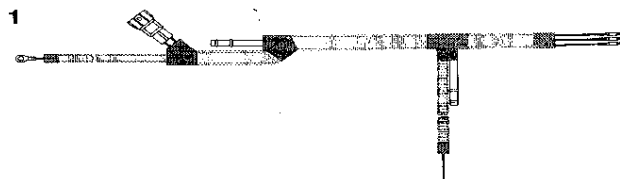

NI = Not Illustrated
NSS = Not Sold Separately

C. Dash Switch Group, P/N 3800359

III.			Qty./
No. P/N	Description	Group	
1 NSS	Dash switch/harness assy.	1	
NI NSS	Connector Housing	1	
NI NSS	Terminal	1	
NI NSS	Conduit, 16 1/2" long	1	

1

D. Pneumatic Group, P/N 3800358

III.			Qty./
No. P/N	Description	Group	
1 3933133	Vacuum solenoid assembly	1	
2 NSS	Hose Barb Fitting (1/4" hose to 1/4" NPT)	1	
3 NSS	90° elbow (1/4" hose to 1/4" NPT)	1	
3800454	Bracket Group		
4 NSS	Mounting plate	1	
5 NSS	Isolator grommets	4	
6 NSS	Fender washer	4	
7 NSS	Lock washer, M6	4	
8 NSS	Hex bolt, M6 x 1 x 40	4	
NI NSS	Well nut	4	
NI NSS	Machine screw, #8-32 x 3/8"2	4	
NI NSS	Lock washer, #8	2	
NI NSS	Hose, 1/4" I.D. x 6"	2	
NI NSS	Hose, 1/4" I.D. x 30"	2	
NI NSS	Hose, 1/4" I.D. x 1.5"	1	
NI NSS	"Y" connector, (1/4" x 1/4" x 1/4")	1	
NI NSS	Hose clamps	1	
NI NSS	Lock nut, M6 x 1	1	
9 NSS	P-clip	1	
NI NSS	Cable ties	12	

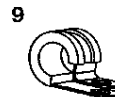
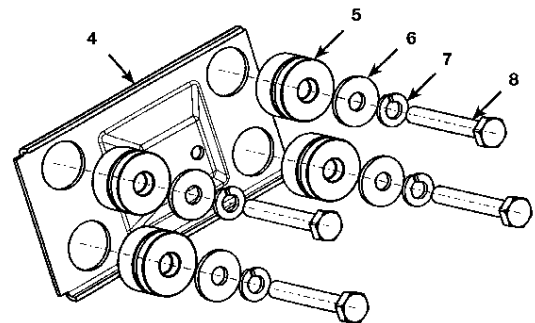
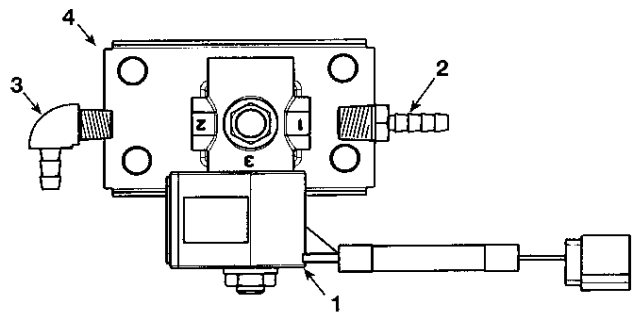

NI = Not Illustrated
NSS = Not Sold Separately



E BRAKE
by Jacobs®



**Cummins Engine Company, Inc.
Box 3005
Columbus, IN 47202-3005
U.S.A.**

Bulletin 3401829
Printed in U.S.A. 3/02
©2002 Cummins Engine Company, Inc. and
Jacobs Vehicle Systems, Inc.

P/N 028539 Rev B